

VENUE PROFILE

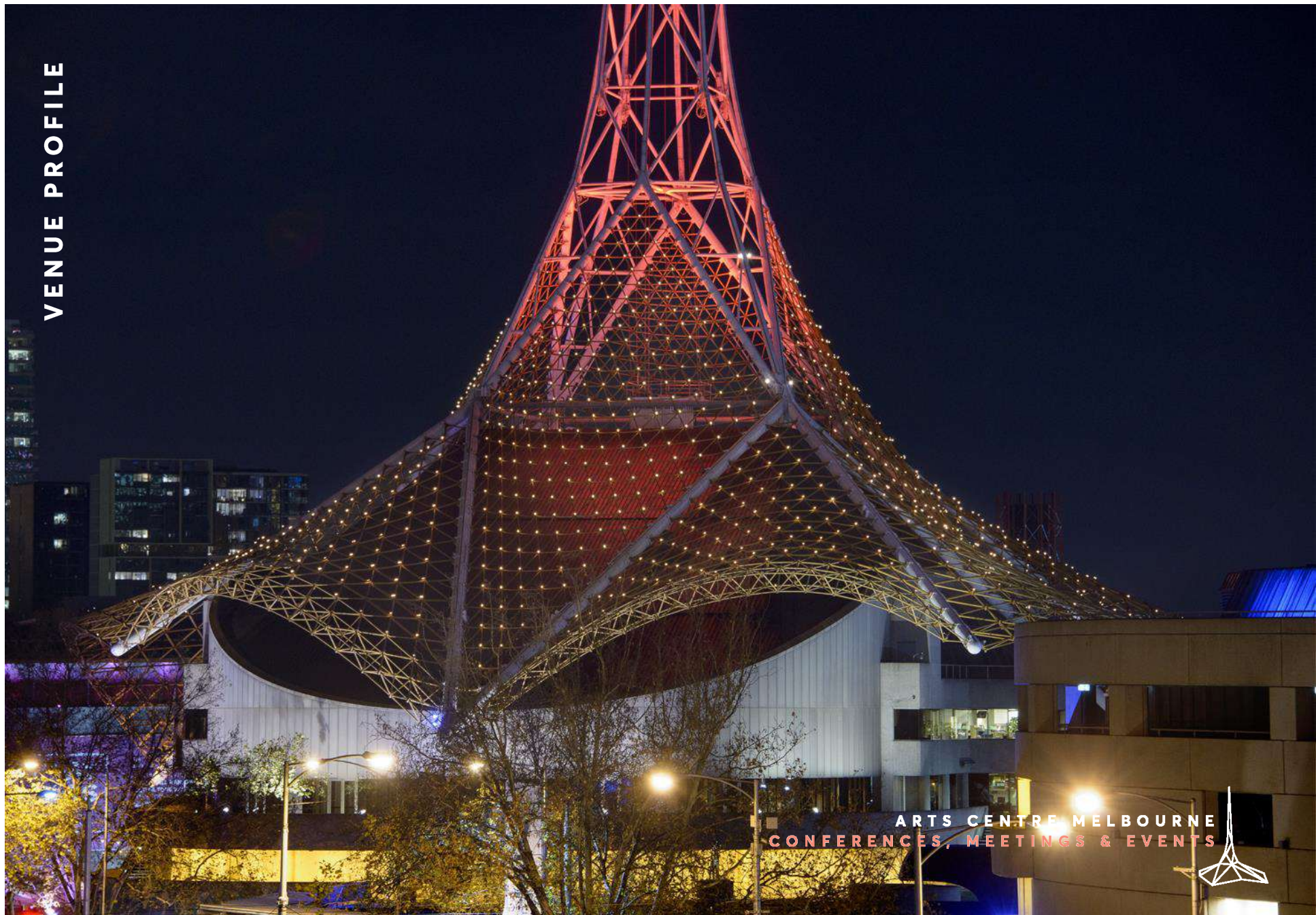

ARTS CENTRE MELBOURNE  
CONFERENCES, MEETINGS & EVENTS



# ABOUT US



**Make your next event memorable in one of the unique conference, meeting and event spaces at Arts Centre Melbourne. Located in the heart of the Melbourne Arts Precinct, under its famous Spire, Arts Centre Melbourne brings style, sophistication and a point of difference to your next event.**









From light-filled contemporary conferencing spaces boasting stunning city views to intimate spaces featuring rich earthy tones each of Arts Centre Melbourne's spaces offer an exciting and memorable point of difference guaranteed to bring the wow factor to your next event. Inside the architectural marvels of Hamer Hall and the Theatres Building created by Sir Roy Grounds, each space features an individual theme conceived by Academy Award winning film designer John Truscott.

The highly-qualified team at Arts Centre Melbourne ensures every event is delivered in a seamless fashion by providing expert advice and assistance every step of the way. From an initial meeting with a sales manager, through to event execution with a professional event manager, our passionate and dedicated team takes the stress out of planning events.

We look forward to making your next event remarkable.

**ARTS CENTRE MELBOURNE**  
CONFERENCES, MEETINGS & EVENTS

# VENUE CAPACITIES

	 Cocktail	 Banquet	 Cabaret	 Theatre	 Boardroom	 Classroom	 U-Shape	 Area sq. m
<b>The Pavilion</b>	500 / 700*	300	240	350	84	120	26	510
<b>Members Lounge</b>	100	80	56	78	38	24	24	170
<b>Hugh Williamson Room</b>	40	22	-	25	20	-	-	45
<b>Ancor Lounge</b>	90	60	40	70	24	42	18	136
<b>State Theatre Lounge</b>	70	40	32	40	20	18	15	116
<b>Riverside Mezzanine</b>	100	50	40	50	34	-	-	200
<b>Melbourne Room</b>	40	20	18	40	22	-	-	61

\* 700 pax combined with The Pavilion Foyer



ARTS CENTRE MELBOURNE  
CONFERENCES, MEETINGS & EVENTS

THE PAVILION



ARTS CENTRE MELBOURNE  
CONFERENCES, MEETINGS & EVENTS

THE PAVILION



ARTS CENTRE MELBOURNE  
CONFERENCES, MEETINGS & EVENTS

# THE PAVILION



**With floor to ceiling windows and views of Melbourne's CBD, The Pavilion makes its mark on the event landscape.**

The largest of Arts Centre Melbourne's private event spaces, The Pavilion features a spectacular domed ceiling, gold leaf interiors and a wraparound balcony. Boasting magnificent views over the Yarra River and city skyline, this versatile and light-filled space is easily accessible and can be transformed to suit your every event requirement.

## **FEATURES:**

**Natural light**

**Domed ceiling with feature lighting**

**Private balcony**

**Private bathrooms**

**Large private foyer area**

**Cloak room**

**Additional 10-seater meeting room**

**Wi-Fi**

**Virtual Tour - [Click here](#)**



Cocktail  
500 / 700\*



Banquet  
300



Cabaret  
240



Theatre  
350



Classroom  
120



Area sq. m  
510

\* 700 pax combined with The Pavilion Foyer

# THE PAVILION

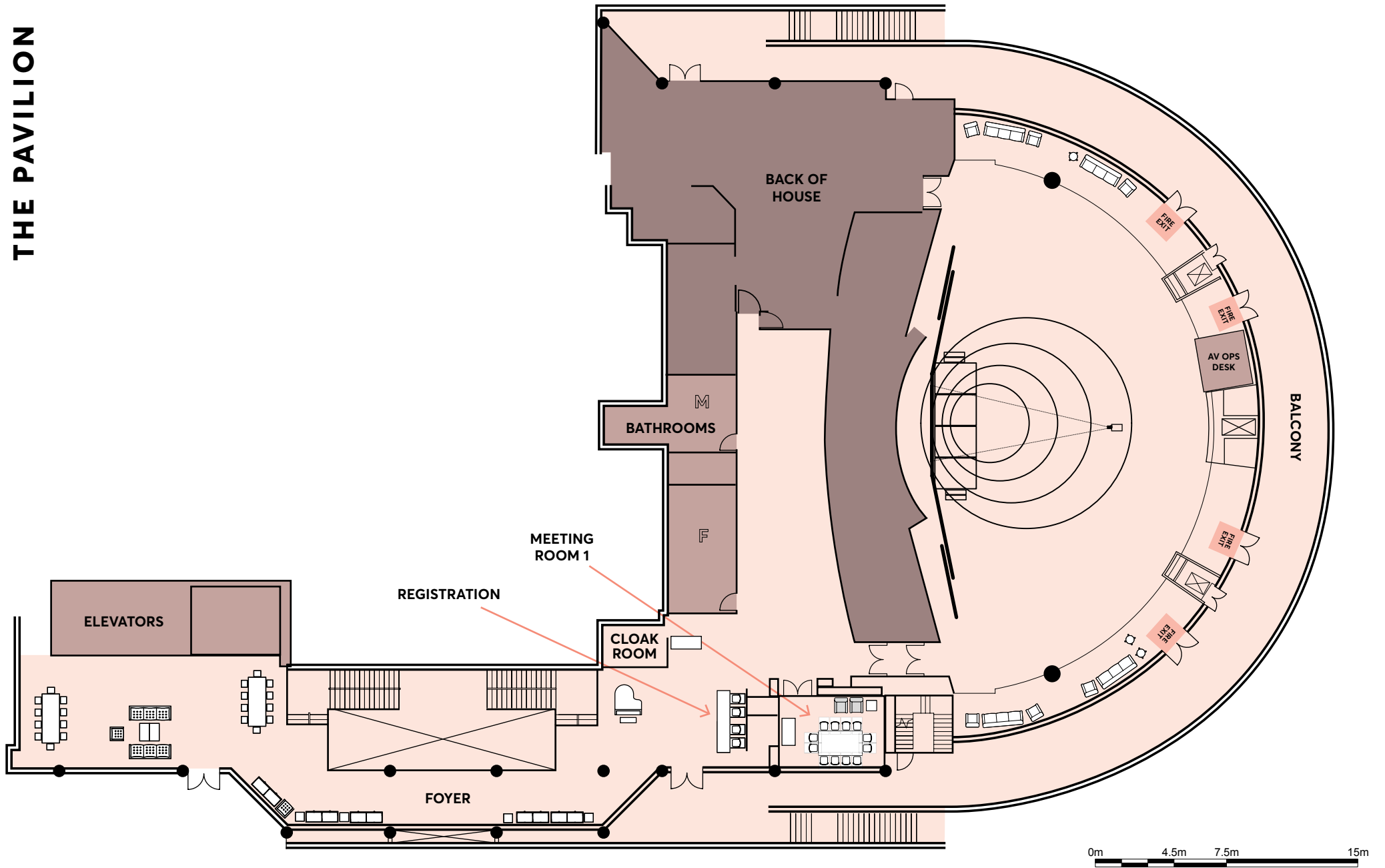

MEMBERS LOUNGE



ARTS CENTRE MELBOURNE  
CONFERENCES, MEETINGS & EVENTS



MEMBERS LOUNGE

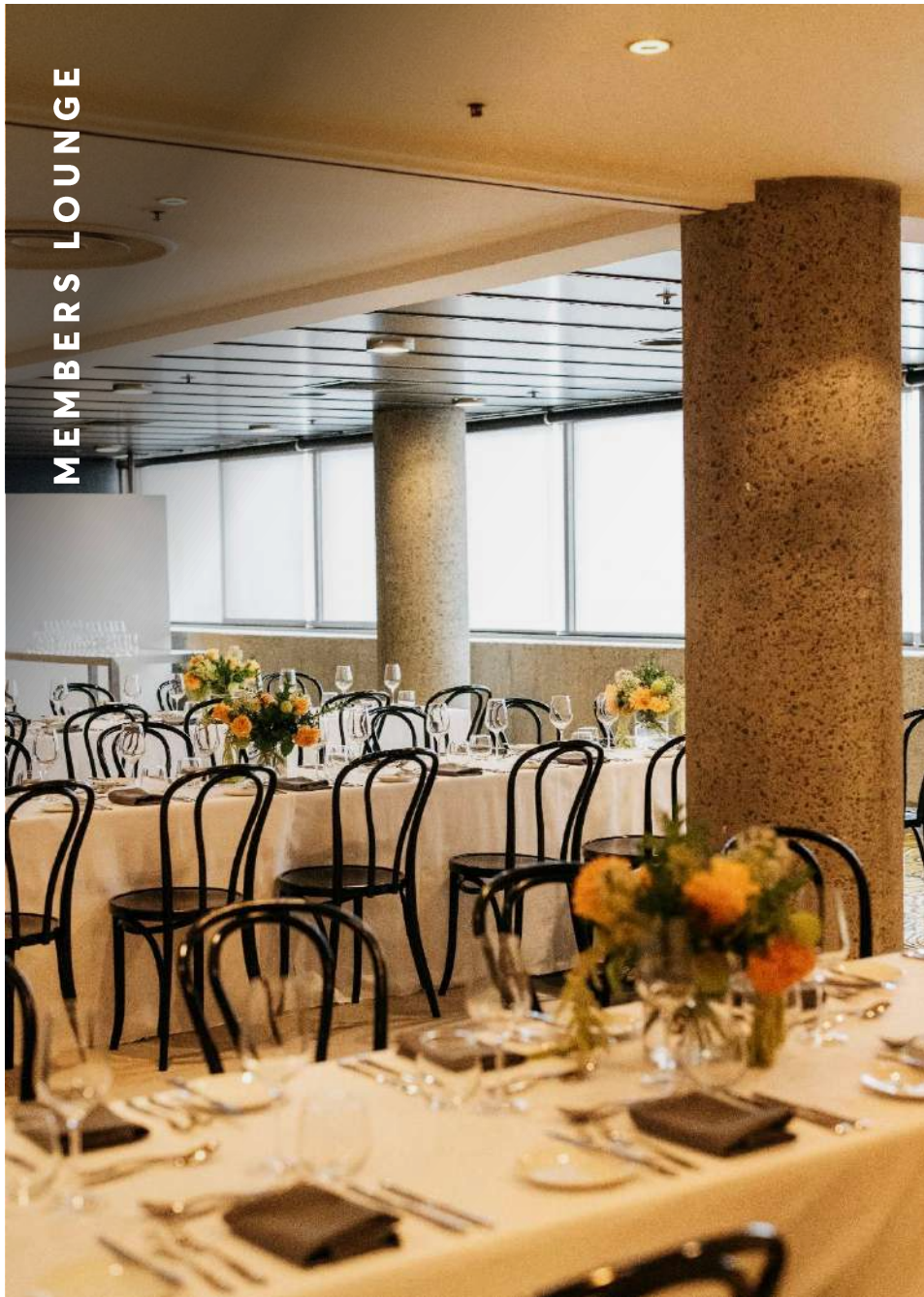

ARTS CENTRE MELBOURNE  
CONFERENCES, MEETINGS & EVENTS

# MEMBERS LOUNGE

**Transformative by nature, the Members Lounge is a light-filled oasis nestled in the iconic Theatres Building.**

The Members Lounge is an open, bright space with a neutral design that can be tailored to suit all of your event aspirations.

With a in-built coffee machine and bar, the Members Lounge takes your event from breakfast to dinner, in style.

## FEATURES:

**Natural light**

**Private bathrooms**

**Separate foyer area**

**Wi-Fi**

**Virtual Tour - [Click Here](#)**



Cocktail  
100



Banquet  
80



Cabaret  
56



Theatre  
78



Boardroom  
38



Area sq. m  
170

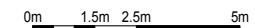
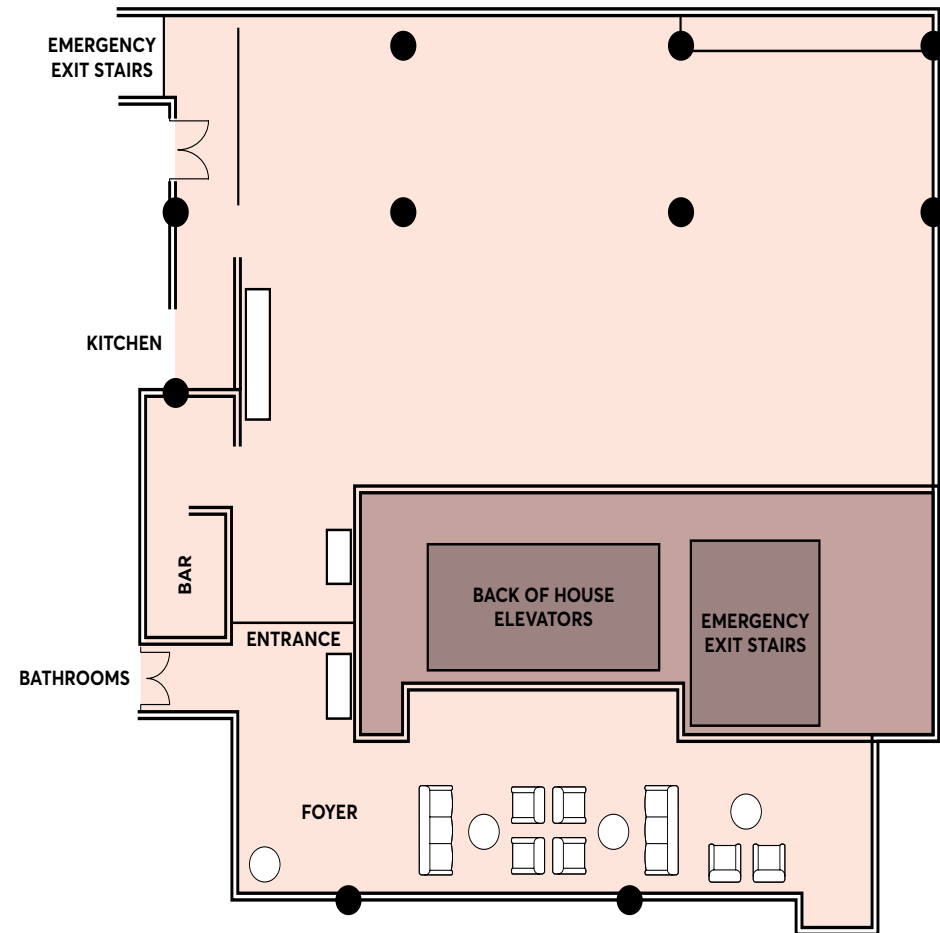

Revised: 15/05/2020 10:22:11

HUGH WILLIAMSON ROOM



ARTS CENTRE MELBOURNE  
CONFERENCES, MEETINGS & EVENTS

HUGH WILLIAMSON ROOM

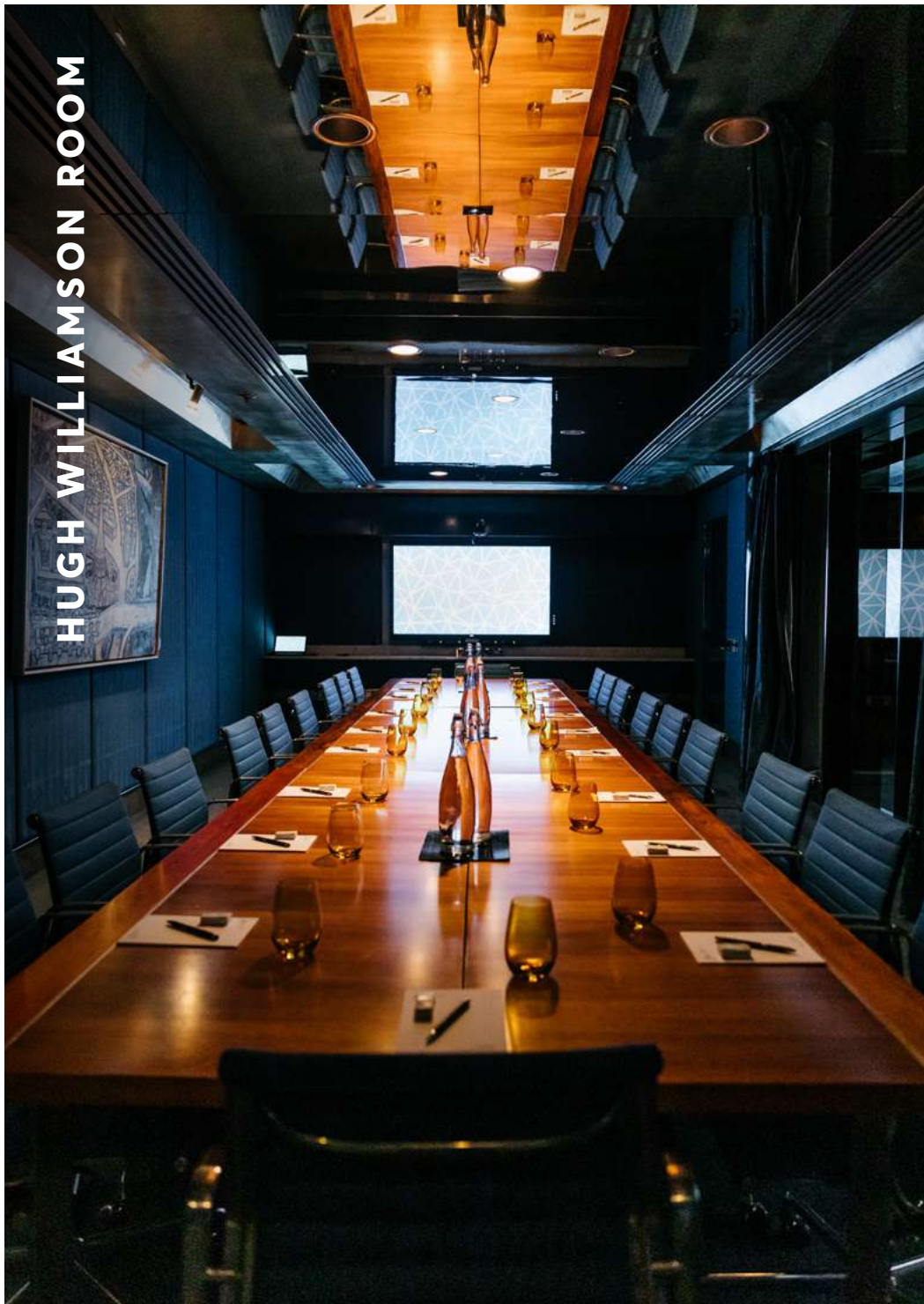

ARTS CENTRE MELBOURNE  
CONFERENCES, MEETINGS & EVENTS

# HUGH WILLIAMSON ROOM

**From boardroom meetings to cocktails, the Hugh Williamson Room is bold luxury in the Melbourne Arts Precinct.**

Boasting spectacular views over St Kilda Road towards Queen Victoria Gardens, the Hugh Williamson Room is one of Arts Centre Melbourne's most popular event spaces. With floor to ceiling windows, ample natural light and a private adjoining balcony, the Hugh Williamson Room transforms easily between boardroom functions, intimate dinners and cocktail parties. With a bold azure-toned interior, charming entrance lounge and private bathroom facilities; this is a hidden gem.

## FEATURES:

**Natural light**

**Private balcony**

**Private bathrooms**

**Annex lounge entry**

**Wi-Fi**

**Virtual Tour - [Click Here](#)**

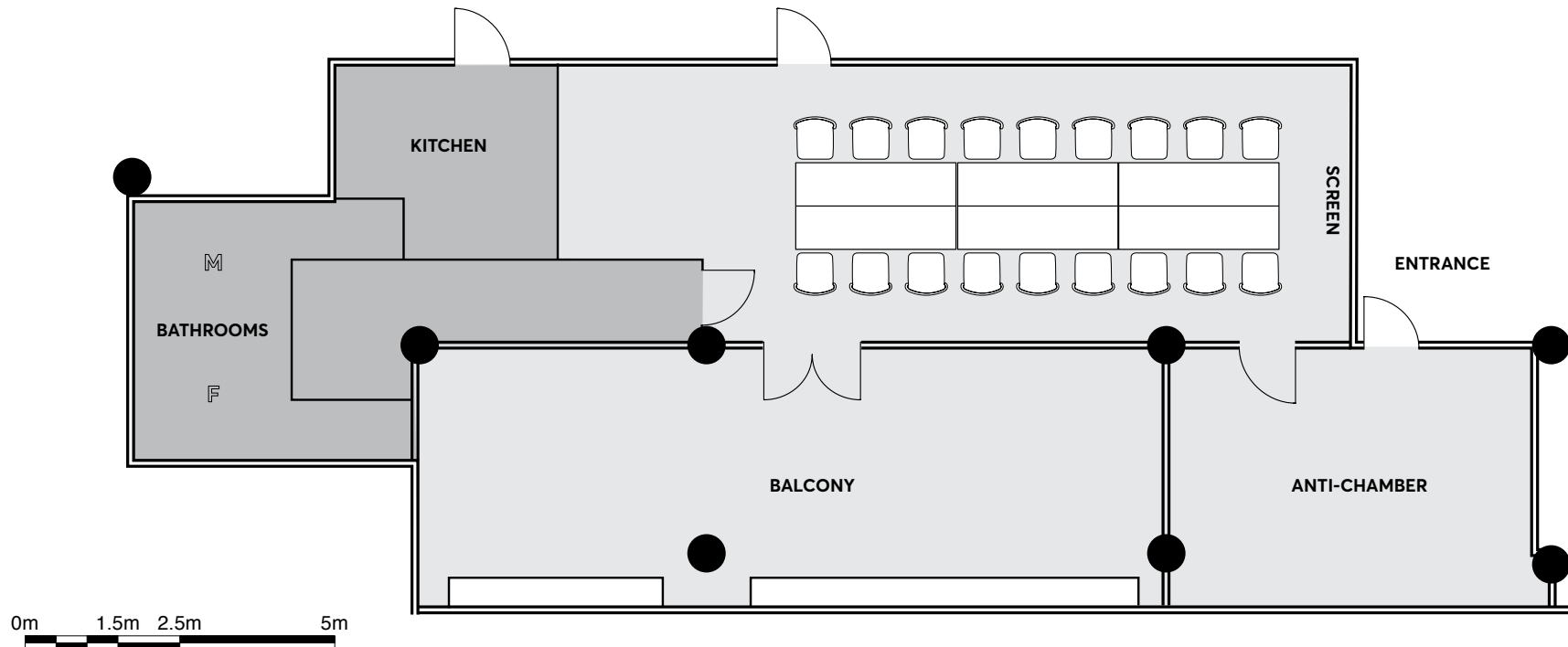
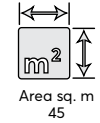

AMCOR LOUNGE



ARTS CENTRE MELBOURNE  
CONFERENCES, MEETINGS & EVENTS

AMCOR LOUNGE



ARTS CENTRE MELBOURNE  
CONFERENCES, MEETINGS & EVENTS

# AMCOR LOUNGE

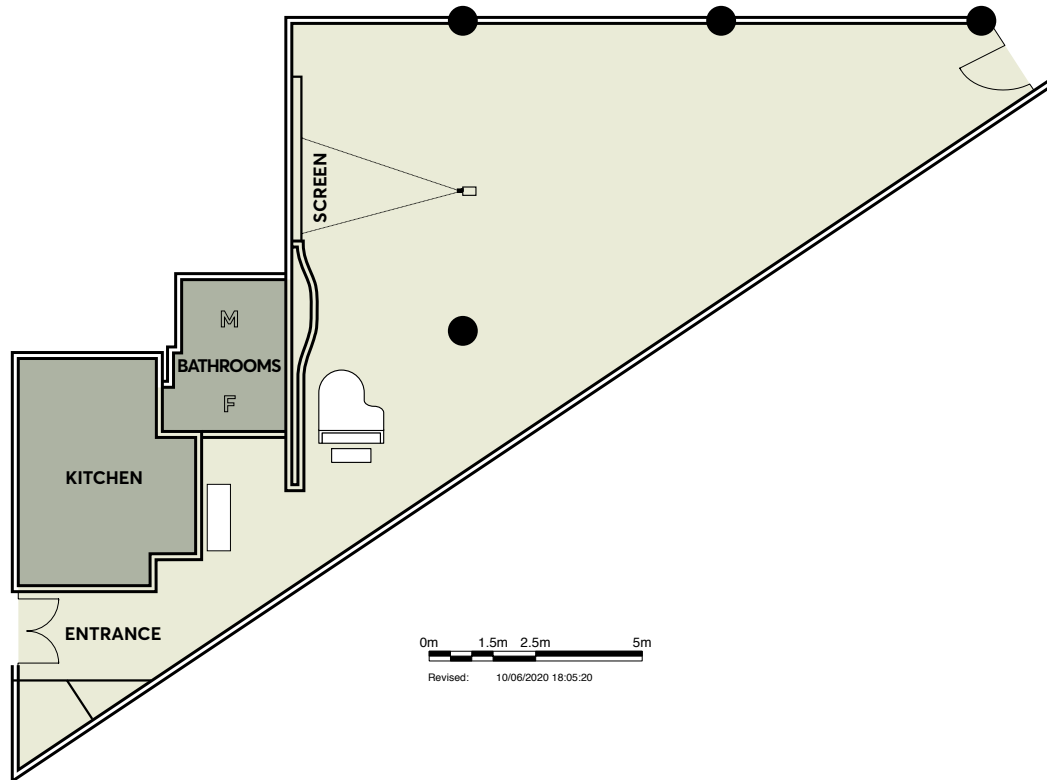

## Set the contemporary tone for your next event with the Amcor Lounge.

The Amcor Lounge is a contemporary event space and home to a stunning backlit wall comprising more than 464,000 marbles and memorabilia. This unique artwork creates the illusion of bubbles suspended in water, providing a kaleidoscope of colour and interest for your guests. One of Arts Centre Melbourne's largest event spaces, this adaptable lounge is ideal for conferences, cocktail events, large dinner parties or boardroom-style meetings. Looking for a breakout space? Why not partner with the neighbouring State Theatre Lounge.

### FEATURES:







Intimate setting

Baby grand piano

Private bathrooms

Wi-Fi

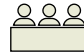
[Virtual Tour - Click Here](#)

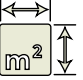
							
Cocktail 90	Banquet 60	Cabaret 40	Theatre 70	Boardroom 24	Classroom 42	U Shape 18	Area sq. m 136



STATE THEATRE LOUNGE



ARTS CENTRE MELBOURNE  
CONFERENCES, MEETINGS & EVENTS



# STATE THEATRE LOUNGE

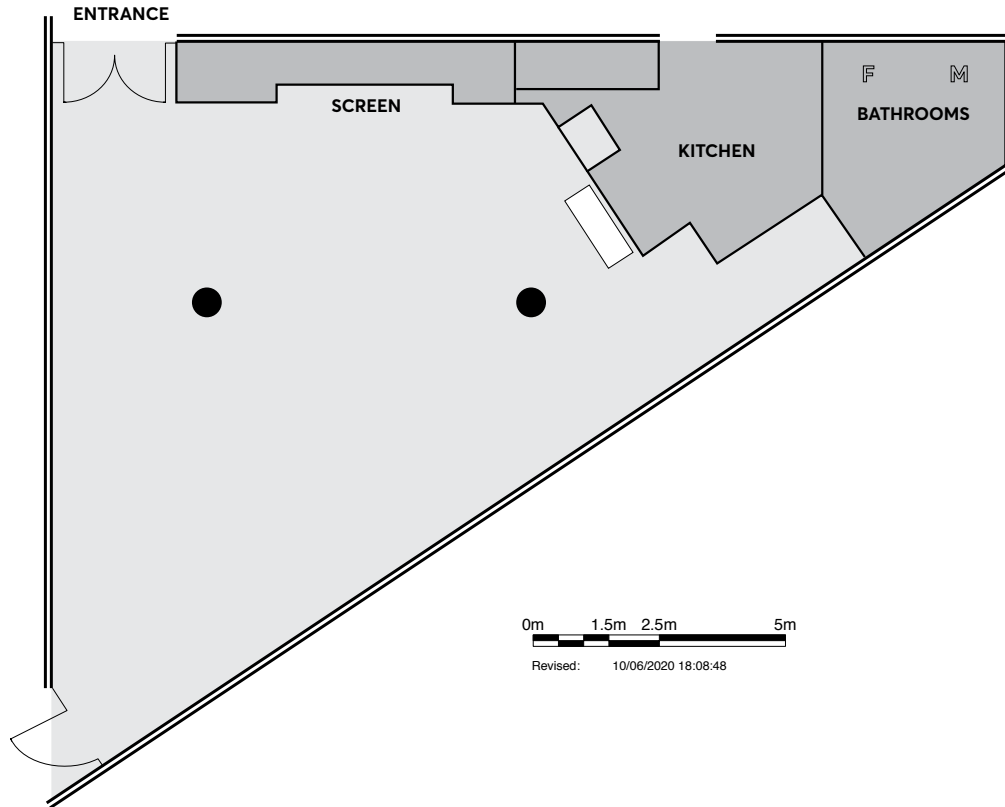

## Make an entrance for your guests in the State Theatre Lounge.

The State Theatre Lounge is one of two adjoining rooms that features a unique and vibrant back-lit artwork, comprising more than 464,000 marbles in a kaleidoscope of colour. This contemporary and creative space is suitable for cocktail parties, breakout meeting areas or as an additional boardroom-style meeting space. Looking for a larger event space? Why not partner with the neighbouring Amcor Lounge.

### FEATURES:

**Intimate setting**

**Private bathrooms**

**Wi-Fi**

**Virtual Tour - [Click Here](#)**

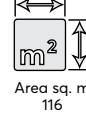

RIVERSIDE MEZZANINE

Door Balcony

Private

ARTS CENTRE MELBOURNE  
CONFERENCES, MEETINGS & EVENTS

RIVERSIDE MEZZANINE

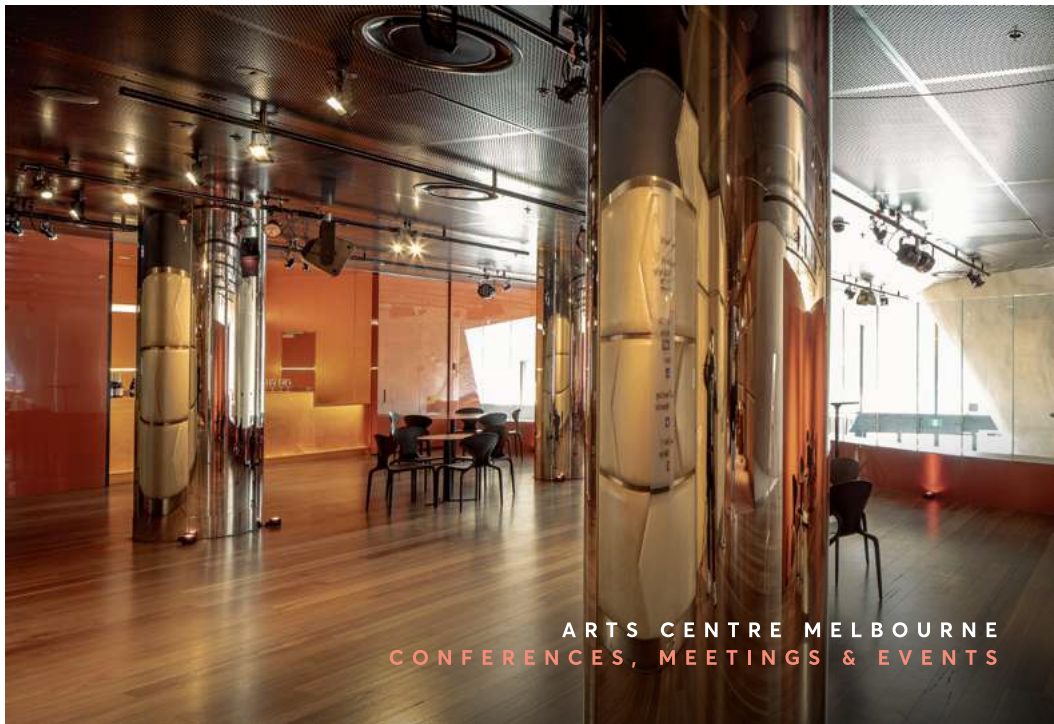

# RIVERSIDE MEZZANINE

An exciting multi-level space nestled on the banks of the Yarra River, Riverside Mezzanine offers a memorable Melbourne backdrop for your event.

Overlooking Melbourne's Yarra River, Riverside Mezzanine is a dynamic and vibrant space.

Bold styling and unobstructed views of the city make Riverside Mezzanine the perfect setting for your next event.

## FEATURES:

City views

Private bathrooms

Wi-Fi

[Virtual Tour - Click Here](#)

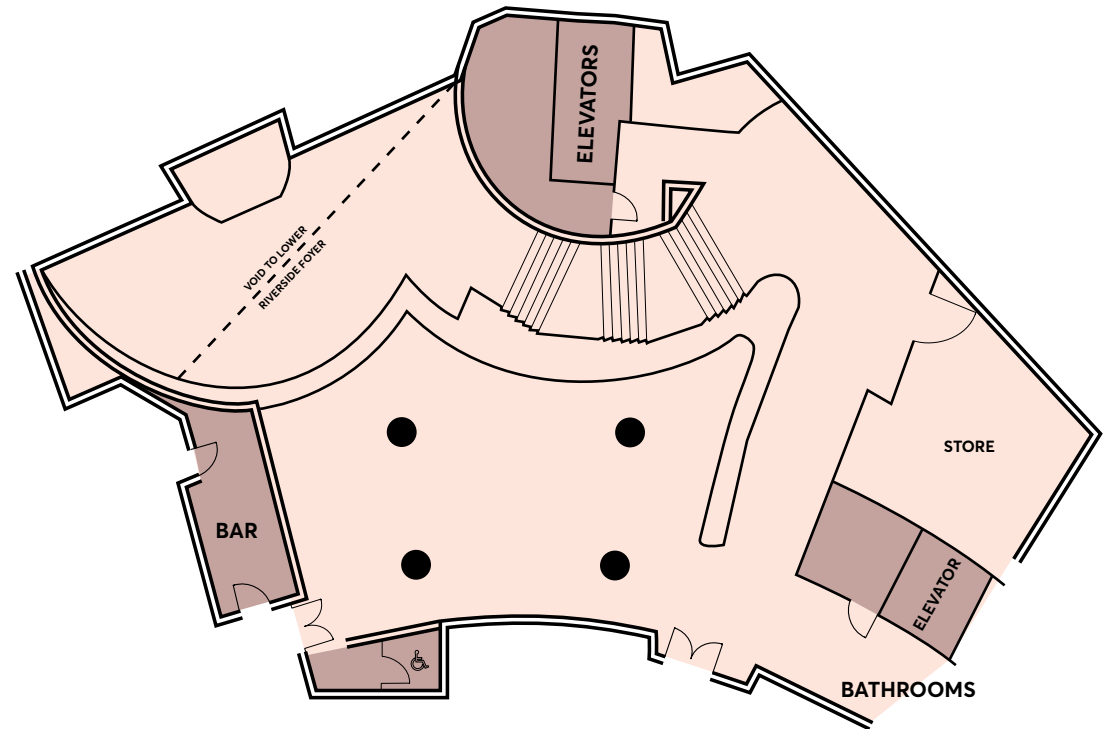

Cocktail  
100



Banquet  
50



Cabaret  
40



Theatre  
50



Boardroom  
34



Area sq. m  
200

APPROX. 18 METERS

MELBOURNE ROOM



ARTS CENTRE MELBOURNE  
CONFERENCES, MEETINGS & EVENTS



MELBOURNE ROOM



ARTS CENTRE MELBOURNE  
CONFERENCES, MEETINGS & EVENTS



# MELBOURNE ROOM

Create a distinguished setting for your next intimate soiree in the Melbourne Room.

The Melbourne Room is an elegant, Deco-inspired event space overlooking the magnificent Stalls Foyer in Hamer Hall. The distinctive circular shape of the Melbourne Room and its exquisite, hand-printed Florence Broadhurst wallpaper provide the inspiration and theming for your next event.

## FEATURES:

- Private bathrooms
- Adjoining annex
- Hamer Hall Stalls Foyer views
- Entry foyer to room
- Wi-Fi

[Virtual Tour - Click Here](#)

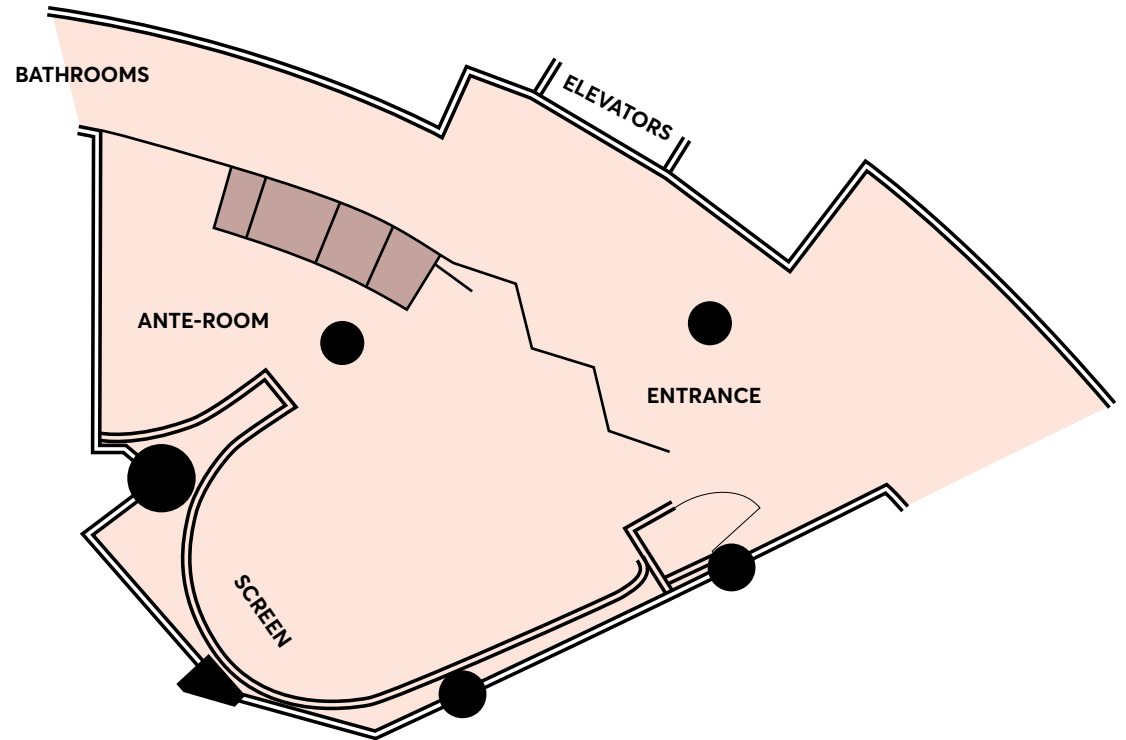

Cocktail  
40



Banquet  
20



Cabaret  
18



Theatre  
40



Boardroom  
22



Area sq. m  
61

0m 1.5m 2.5m 5m



ARTS CENTRE MELBOURNE  
CONFERENCES, MEETINGS & EVENTS

100 St Kilda Road  
Melbourne VIC 3004  
T 03 9281 8350

E [events@artscentremelbourne.com.au](mailto:events@artscentremelbourne.com.au)